

ALTAIR V5 CONCENTRIC

ROTARY PISTON METER

DIEHL
Metering



APPLICATION

ALTAIR V5 CONCENTRIC is the latest generation of volumetric water meters specifically designed for installation on coaxial base in manifold.

ALTAIR V5 CONCENTRIC adapts to the most demanding environments and varying water qualities while maintaining its excellent metrology.

Developed within the MID framework, it complies with European standards and holds certificates of sanitary conformity.

Modular, ALTAIR V5 CONCENTRIC may be fitted at any time with an IZAR clip-on module converting it into a communicating meter, ready for mobile reading (walk-by, drive-by, passive drive-by) or fixed network reading (radio/wired).

FEATURES

- ▶ $Q_3 = 2.5 \text{ m}^3/\text{h}$ / $Q_3 = 4 \text{ m}^3/\text{h}$
- ▶ MID approval up to $R=1000$
- ▶ Starting flow rate at 0.4 l/h (for $Q_3 = 2.5 \text{ m}^3/\text{h}$ and $Q_3 = 4 \text{ m}^3/\text{h}$)
- ▶ Composite or brass body
- ▶ Cold water

ALTAIR V5 CONCENTRIC

ROTARY PISTON METER

METROLOGICAL DATA

Nominal diameter	DN	mm	15	20
Permanent flow rate	Q ₃	m ³ /h	2.5	4
R standard*	Q ₃ /Q ₁		160	160
Body			brass / composite	brass / composite
Starting flow rate		l/h	0.4	0.4
Minimum flow rate*	Q ₁	l/h	15.62	25
Transitional flow rate*	Q ₂	l/h	25	40
Overload flow rate	Q ₄	m ³ /h	3.125	5
Head loss at Q ₃		bar	0.32	0.61
Head loss at Q ₄		bar	0.50	0.94
Kvs (deltaP=Q ² /Kvs ²)			5.13	5.13

*Other values on request

APPROVAL

ALTAIR V5 CONCENTRIC	
MID Approval	LNE-39018 Type A3
Standards	EN 14154 ISO 4064 OIML R49
Sanitary conformity	ACS AoC DEU WRAS

REACH

Information pursuant to Article 33 (1) of Regulation (EC) No 1907/2006 of the European Parliament and of the Council of 18 December 2006:

This product series contains components with the following substances in a concentration of more than 0.1% weight by weight (w/w):

- Lead (CAS no.: 7439-92-1)

TEMPERATURE AND PRESSURE

ALTAIR V5 CONCENTRIC		
Water temperature	°C	0.1 ... +50
Ambient operating temperature	°C	+1 ... +55
Storage temperature	°C	-10 ... +55
Nominal pressure	bar	16

DIMENSIONS

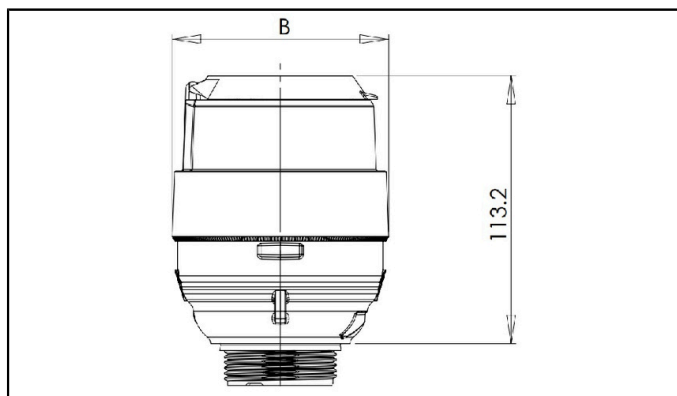

ALTAIR V5 CONCENTRIC		
Height	mm	113.2
Width	mm	91.3
Thread connections	inch	1½
Weight (brass version)	kg	0.82
Weight (composite version)	kg	0.39

ALTAIR V5 CONCENTRIC

ROTARY PISTON METER

Fitting and removing wrench

A special wrench is required for fitting or removing the meter (contact Diehl Metering). The two seals remain on the meter when it is removed.

PRECISION CURVE

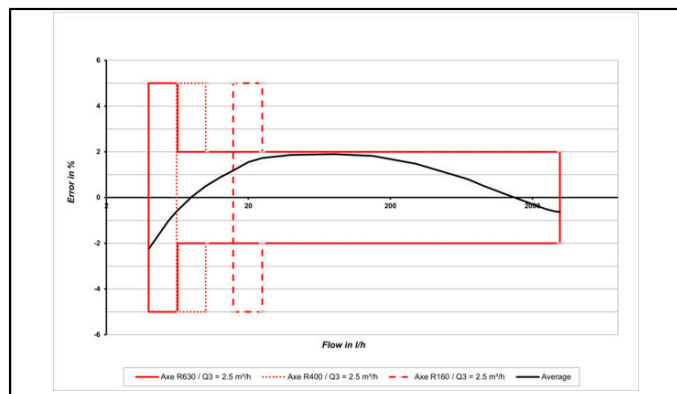

$Q_3 = 2.5$ R160

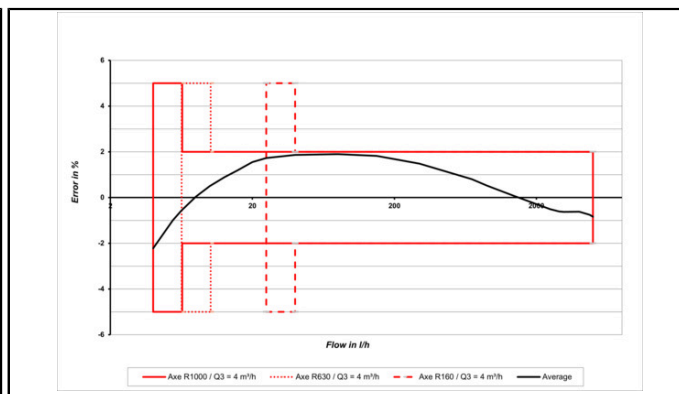

$Q_3 = 4$ R160

OPTION

- Plastic register