

DMA STANDARD PINS FOR SINGLE PIN INSERTION (SPI)

4,8 X 0,8 PRESS-FIT PIN

SPECIFICATIONS

Material: CuNi3SiMg R620 (C70250)
 Electrical conductivity: 43% IACS
 Type of press-fit zone: EE08

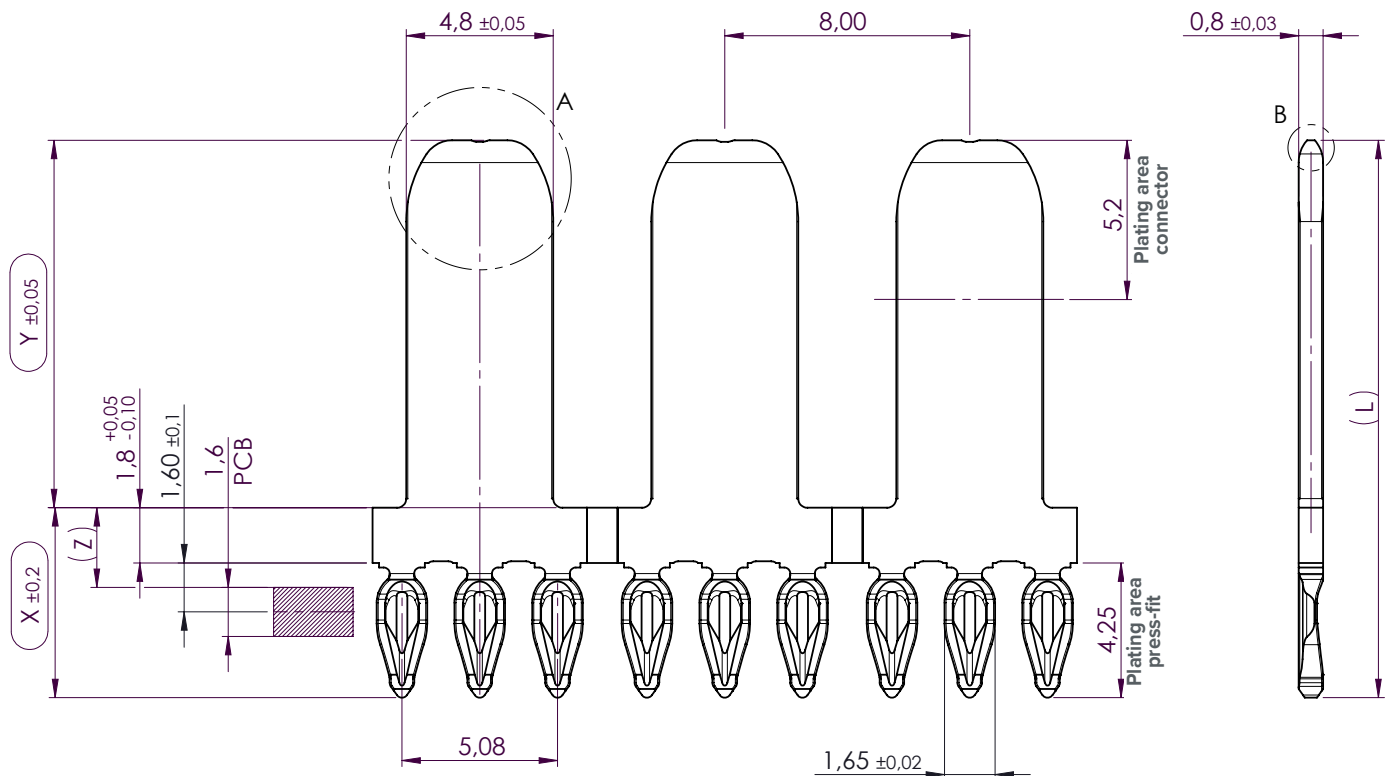

Dimensions [mm]

| X | Y | Z | L |
|------|------|-----|-------|
| 6,05 | 10,5 | 2,6 | 16,55 |
| 6,05 | 11,5 | 2,6 | 17,55 |

Connector plating variants

- Ni 1,0 - 2,2µm, Sn mt 1 - 3µm
- Ni 1,0 - 3,0µm, Ag 1,5 - 5,0µm*2
- Ni 1,0 - 2,2µm, Au 0,8 - 2,0µm*1

*1 (AuCo alloy (Hard gold) with 0.2 - 0.3 % Co)
 *2 (Fine silver with 75 - 95 HV and Thiol passivation)

Press-fit zone plating variants

- Ni 1 - 3µm, Sn mt 0,3 - 1,1µm
- Ni 1 - 3µm, DMA Adv. Indium 0,3 - 1,1µm
- Ni 1,3 - 2,2µm, DMA Adv. AgSn 0,35 - 0,75µm

4,8 X 0,8 PRESS-FIT PIN

PARAMETER

Press-fit connection

| | |
|----------------------------|--------------|
| Operating temperature [°C] | -40 bis +150 |
| Push-in force [N] | < 150 |
| Push-out force [N] | > 25* |
| Contact resistance [μOhm] | ≤ 300 |

*Typical force limit for nominal hole

Tested according to IPC-9797 on test PCBs

Printed circuit board (PCB)

| | |
|---|---------------|
| Final hole diameter [mm] | 1,45 + 0,1 |
| Copper thickness Plated-Through Hole [μm] | > 25 ... ≤ 55 |
| Surface finish | iSn OSP |
| PCB thickness [mm] | 1,6 ± 10% |
| Annular ring [mm] | 0,25 – 0,35 |
| Material quality | min. FR4 |

Derating graph for press-fit type EE08

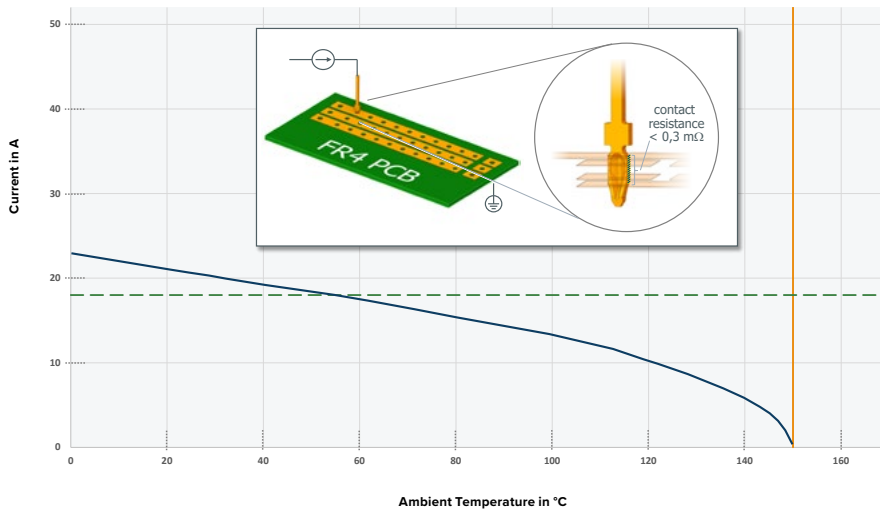

Derating measurement acc. to DIN EN 60512-5-3

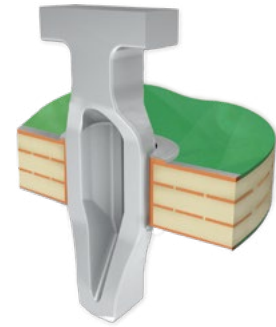

Limit temperature ————

Derating graph ————

Max. test current - - - - -

PACKAGING

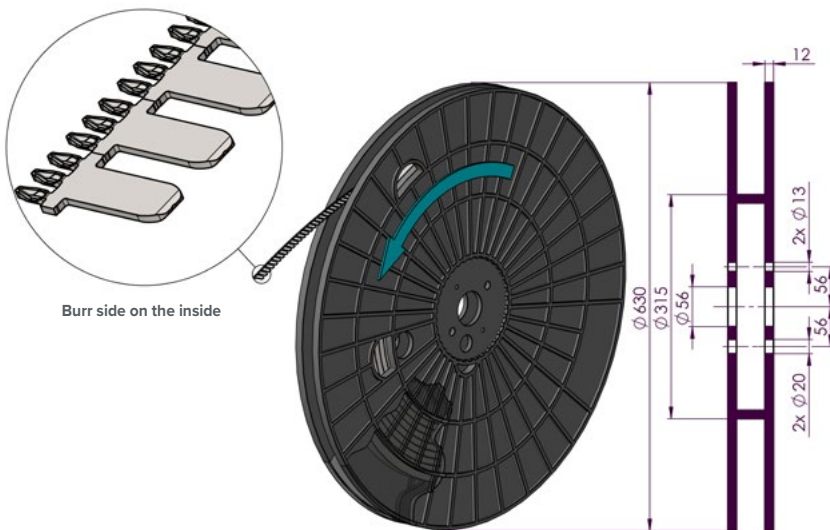

Reel type: Haefner tape reel BSL

| Connector length [mm] | Quantity per reel [approx. pcs.] | Weight per reel [approx. kg] |
|-----------------------|----------------------------------|------------------------------|
| 10,5 | 25.000 | 15,0 |
| 11,5 | 25.000 | 15,0 |

Maximum 2 cut-off points; not attached

For further processing and storage, please refer to the information sheet on the handling of our flexible press-fit zones.



Please scan the QR code to get to the order form.