

A (10 : 1)

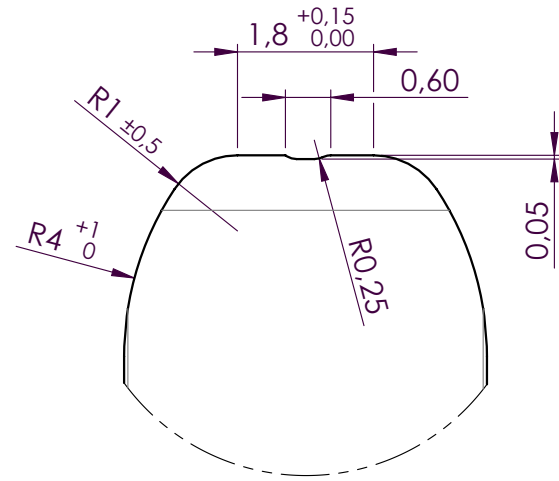

B (20 : 1)

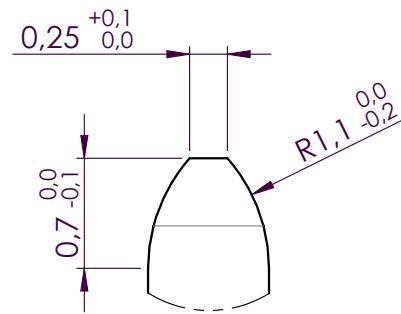

| Dimension "X±0,2" | Dimension "Y±0,05" | Dimension "Z" | Dimension "L" |
|-------------------|--------------------|---------------|---------------|
| 6,05              | 10,5               | 2,6           | 16,55         |
| 6,05              | 11,5               | 2,6           | 17,55         |

| Plating variants                           |
|--|
| Press-fit zone                             |
| Ni 1 - 3µm,<br>Sn mt 0,3 - 1,1µm           |
| Ni 1 - 3µm,<br>Adv. Indium 0,3 - 1,1µm     |
| Ni 1,3 - 2,2µm,<br>Adv. AgSn 0,35 - 0,75µm |

| Plating variants                     |
|--------------------------------------|
| Connector side                       |
| Ni 1,0 - 2,2µm,<br>Sn mt 1 - 3µm     |
| Ni 1,0 - 3,0µm,<br>Ag 1,5 - 5,0µm *2 |
| Ni 1,0 - 2,2µm,<br>Au 0,8 - 2,0µm *1 |

\*1 (AuCo - alloy (hard gold) with 0,2 - 0,3%Co)

\*2 (fine silver with 75 - 95HV and Thiol passivation) 03

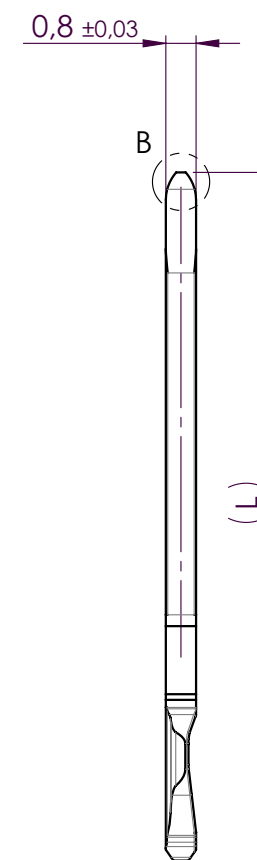
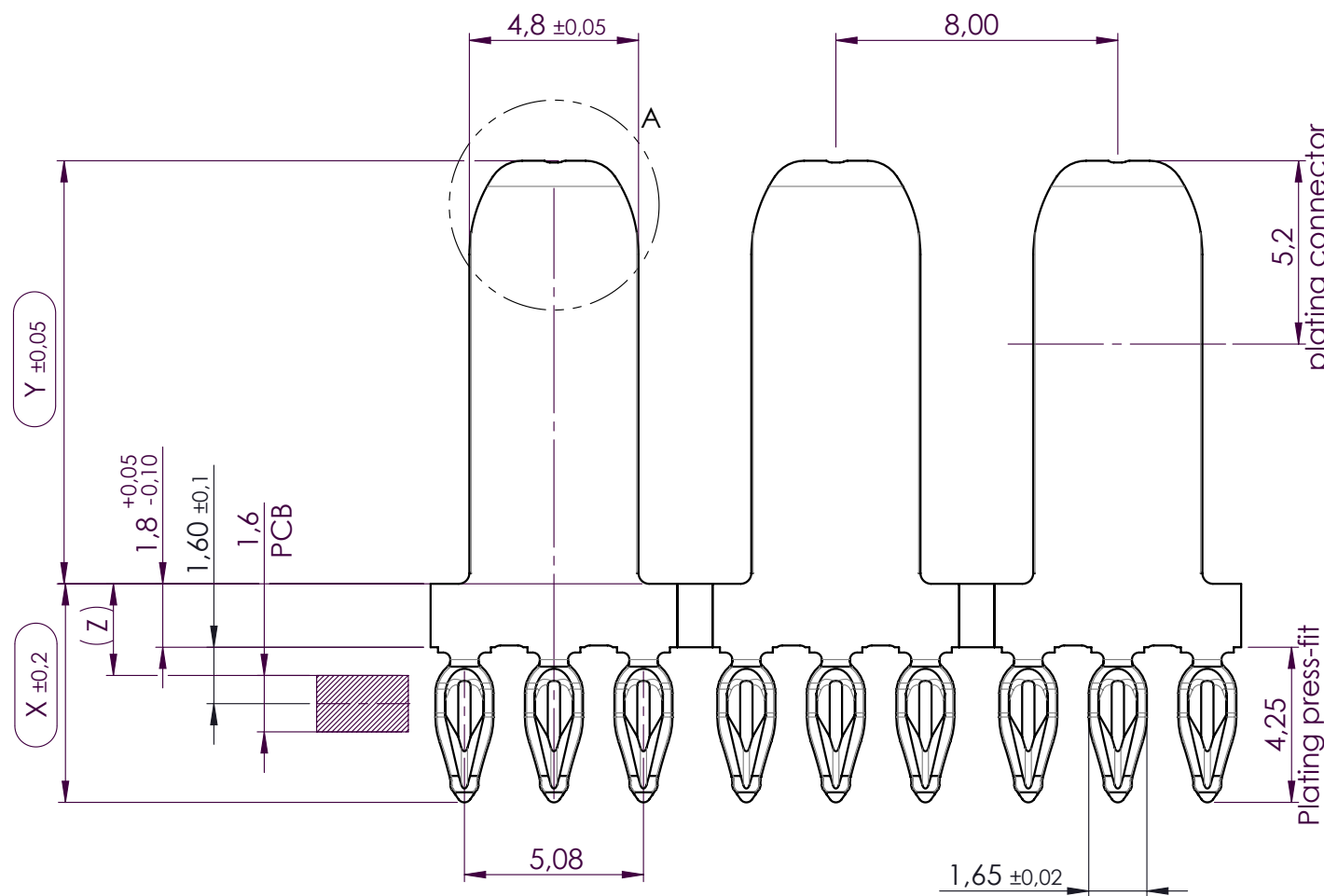

Delivery condition

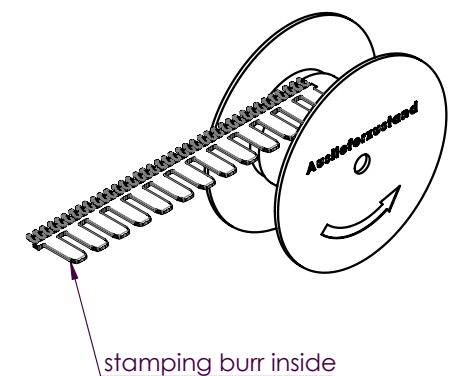

- Press-fit zone according to DMA-drawing 80991
- Product drawing 80953

|  |  |   |   |                         |
|--|--|---|---|-------------------------|
| Erstellt in:<br>SOLIDWORKS                     | Toleranzen<br>DIN ISO 2768-m                 | Maßstab<br>5:1                              | Material<br>CuNiSi (C70250) R620                | Pos. Nr.                |
|  | nicht bemaßte Konturen<br>siehe 3D-Datensatz | Benennung<br>Marketingzeichnung DMA-Katalog | Stk.  |                         |
|  | Datum<br>Bearb. 15.12.2020                   | Name<br>Krause                              | Kontaktstift 4,8 x 0,8<br>Contact Pin 4,8 x 0,8 |                         |
|  | Gepr.  | Norm.                                       |   |                         |
| 03   | "Thiol passivation" hinzu                    | 18.01.2023                                  | Krause  | Zeichn.-Nr.<br>81002-03 |
| 02   | Lage LP auf 1,60                             | 25.02.2021                                  | Sturm   |                         |
| 01   | Zeichnung überarbeitet                       | 21.01.2021                                  | Krause  | Blatt-Nr.<br>.          |
| Zust   | Änderung                                     | Datum                                       | Name  |                         |
| Schutzvermerk nach DIN 34 / ISO 16016 beachten |  |   | Blatt-Format<br>A3                              |                         |